

"FW" PROFILE
SLAB-TO-SLAB CONDITION

() - Denotes Millimeters

Nominal Relaxed Dimensions			Movement Range			
Model	"A"	"B"	J.O. Min.	"C"	J.O. Max.	Total Movement
25FW	1"(25)	1 1/4"(32)	11/16"(17)	1/4"(6)	1 5/16"(34)	5/8"(16)
40FW	1-5/8"(41)	2"(51)	1"(25)	1/4"(6)	2"(51)	1"(25)
50FW	2"(51)	2-1/2"(64)	1-3/8"(35)	1/4"(6)	2-5/8"(66)	1-1/4"(32)
65FW	2-1/2"(64)	3 1/4"(82)	1-5/8"(41)	1/4"(6)	3-3/8"(86)	1-3/4"(44)
75FW	3"(76)	3 3/4"(95)	2"(51)	1/4"(6)	4"(102)	2"(51)
100FW	3 7/8"(100)	5"(127)	2-11/16"(68)	1/4"(6)	5-5/16"(135)	2-5/8"(67)
125FW	5"(127)	6 1/8"(155)	3-3/8"(86)	1/4"(6)	6-5/8"(168)	3-1/4"(83)

PROJECT NAME:
-

PROJECT LOCATION:
-

DRAWING DESCRIPTION:

Wabo®Jeene

DATE: 01/27/2021

MODEL: FW



Watson Bowman Acme
95 Pineview Drive Amherst, NY 14228
phone: (716) 691-7566 fax: (716) 691-9239
www.watsonbowmanacme.com



Information provided herein, including but not limited to, any drawing, design, photograph, graphic, or statement(s) ("Materials") are proprietary and the property of Watson Bowman Acme Corporation ("Company"). Reproduction, translation, or reduction to any electronic medium or machine readable form, in whole or part, is strictly prohibited, except for the express purpose for which it has been furnished, without prior written consent of Company. All Materials contained herein are provided by Company for information purposes only. Company reserves the right to amend or withdraw any information contained in the Materials without notice. All technical or other advice by Company, whether verbal or written, concerning products, or the use of products in specific situations ("Advice") is given by Company and is used at the Users own risk.

REVISION NO:

1

SHEET NO:

1

DRAWING NO:

C-96011

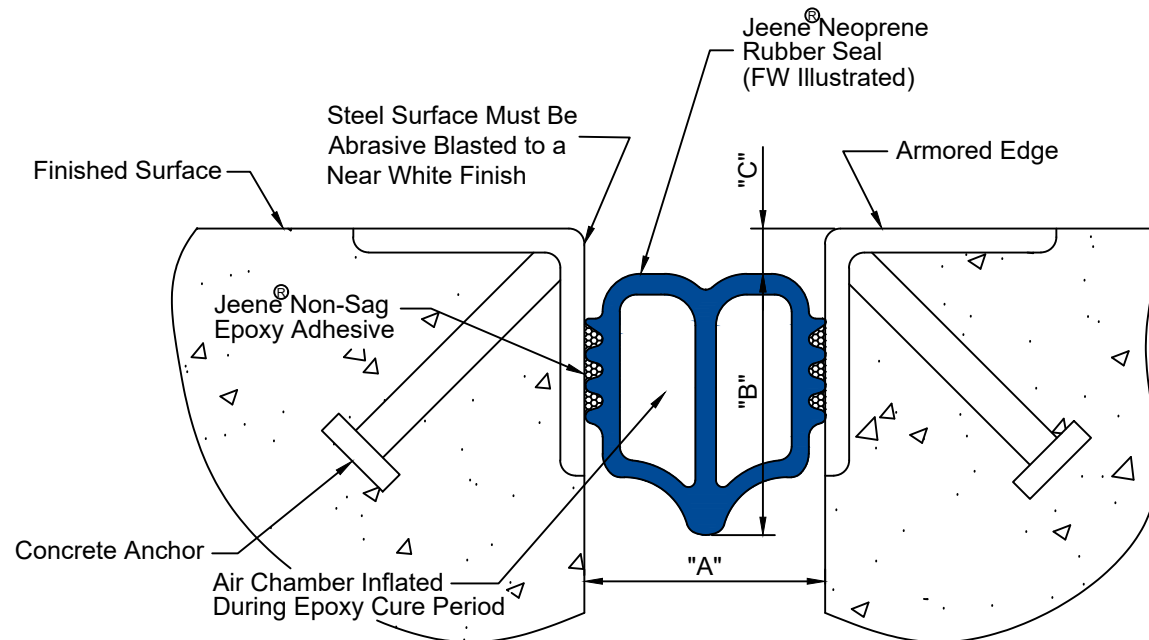

ARMORED CONDITION

SLAB-TO-SLAB CONDITION

() - Denotes Millimeters

Nominal Relaxed Dimensions			Movement Range			
Model	"A"	"B"	J.O. Min.	"C"	J.O. Max.	Total Movement
25FW	1"(25)	1 1/4"(32)	11/16"(17)	1/4"(6)	1 5/16"(34)	5/8"(16)
40FW	1-5/8"(41)	2"(51)	1"(25)	1/4"(6)	2"(51)	1"(25)
50FW	2"(51)	2-1/2"(64)	1-3/8"(35)	1/4"(6)	2-5/8"(66)	1-1/4"(32)
65FW	2-1/2"(64)	3 1/4"(82)	1-5/8"(41)	1/4"(6)	3-3/8"(86)	1-3/4"(44)
75FW	3"(76)	3 3/4"(95)	2"(51)	1/4"(6)	4"(102)	2"(51)
100FW	3 7/8"(100)	5"(127)	2-11/16"(68)	1/4"(6)	5-5/16"(135)	2-5/8"(67)
125FW	5"(127)	6 1/8"(155)	3-3/8"(86)	1/4"(6)	6-5/8"(168)	3-1/4"(83)

PROJECT NAME: -

PROJECT LOCATION: -

DRAWING DESCRIPTION:

Wabo®Jeene

DATE: 01/28/2021

MODEL: FW



Watson Bowman Acme
95 Pineview Drive Amherst, NY 14228
phone: (716) 691-7566 fax: (716) 691-9239
www.watsonbowmanacme.com



Information provided herein, including but not limited to, any drawing, design, photograph, graphic, or statement(s) ("Materials") are proprietary and the property of Watson Bowman Acme Corporation ("Company"). Reproduction, translation, or reduction to any electronic medium or machine readable form, in whole or part, is strictly prohibited, except for the express purpose for which it has been furnished, without prior written consent of Company. All Materials contained herein are provided by Company for information purposes only. Company reserves the right to amend or withdraw any information contained in the Materials without notice. All technical or other advice by Company, whether verbal or written, concerning products, or the use of products in specific situations ("Advice") is given by Company and is used at the Users own risk.

REVISION NO:

1

SHEET NO:

11

DRAWING NO:

C-96011

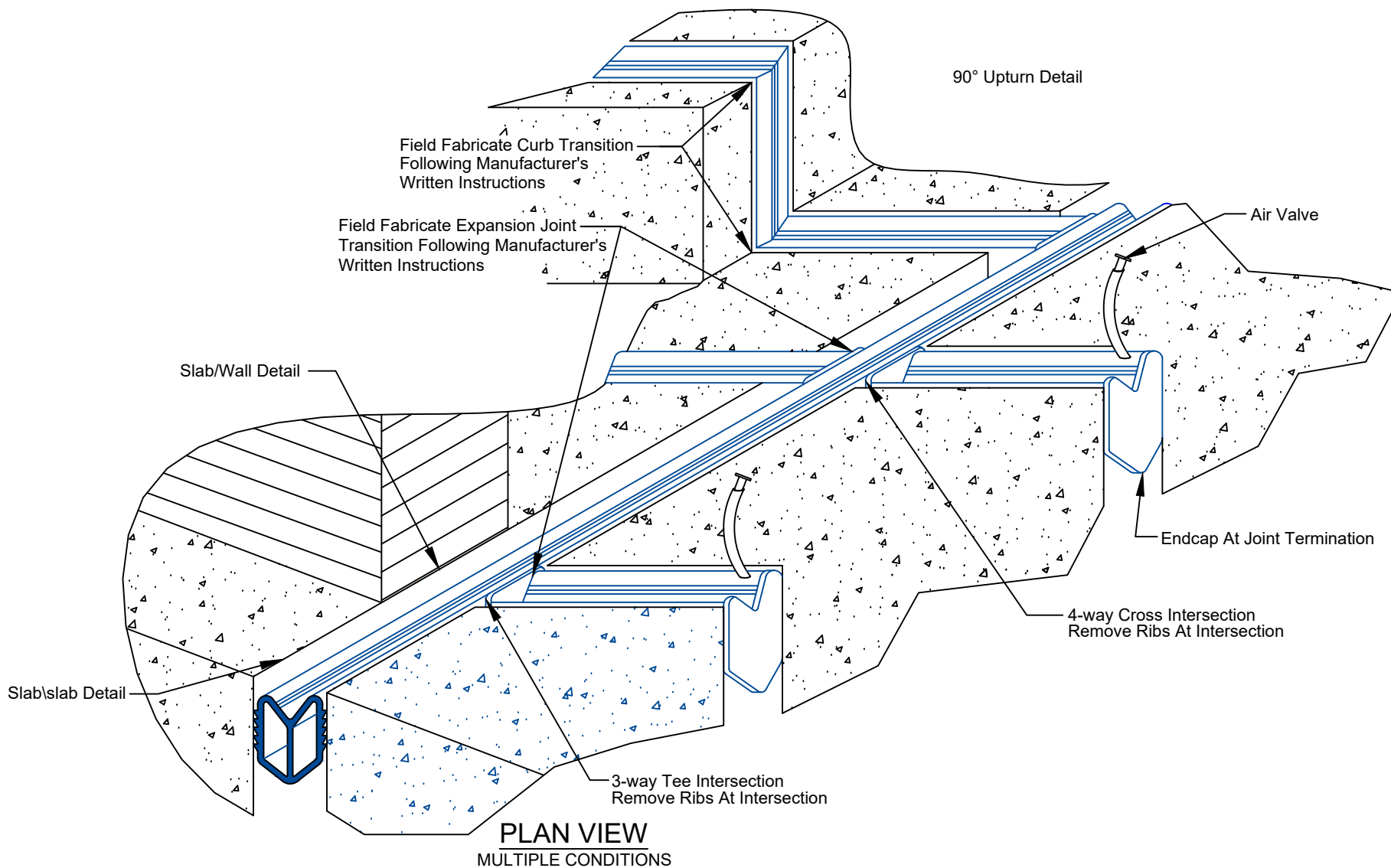

PROJECT NAME: -

PROJECT LOCATION: -

DRAWING DESCRIPTION:

Wabo®Jeene

DATE: 01/28/2021

MODEL: FW & W



Watson Bowman Acme
95 Pineview Drive Amherst, NY 14228
phone: (716) 691-7566 fax: (716) 691-9239
www.watsonbowmanacme.com



Information provided herein, including but not limited to, any drawing, design, photograph, graphic, or statement(s) ("Materials") are proprietary and the property of Watson Bowman Acme Corporation ("Company"). Reproduction, translation, or reduction to any electronic medium or machine readable form, in whole or part, is strictly prohibited, except for the express purpose for which it has been furnished, without prior written consent of Company. All Materials contained herein are provided by Company for information purposes only. Company reserves the right to amend or withdraw any information contained in the Materials without notice. All technical or other advice by Company, whether verbal or written, concerning products, or the use of products in specific situations ("Advice") is given by Company and is used at the Users own risk.

REVISION NO:

1

SHEET NO:

4

DRAWING NO:

C-96011

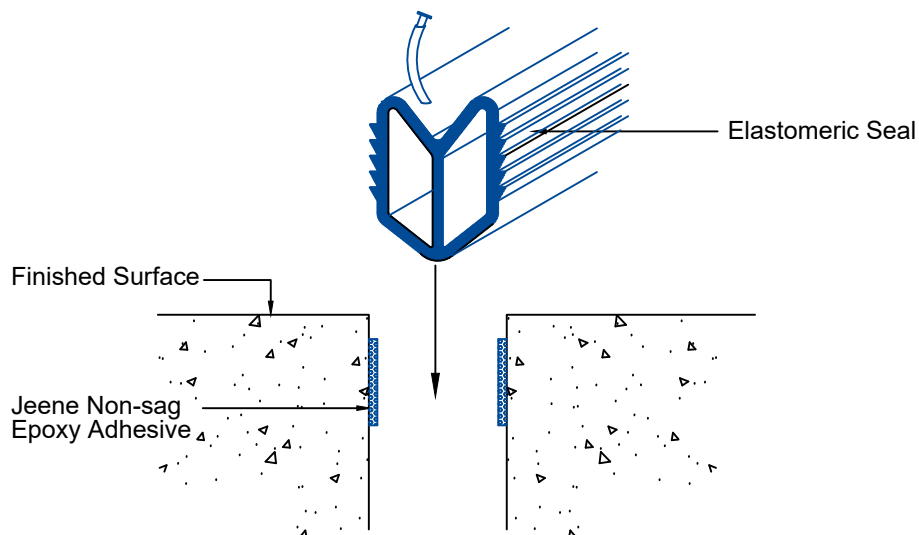

APPLY JEENE® ADHESIVE TO SIDEWALLS AFTER CONTAMINANTS ARE REMOVED BY GRITBLASTING. CLEAN PROFILE WITH JEENE SOLUTION SUPPLIED AND APPLY ADHESIVE TO PROFILE.

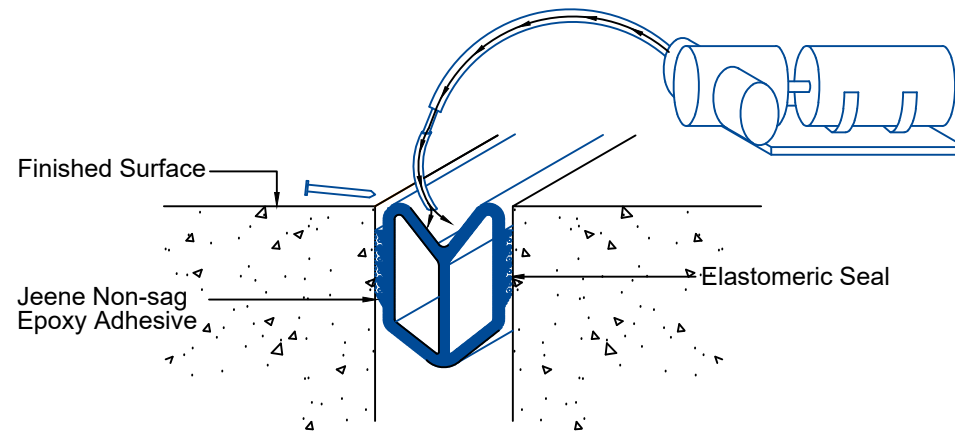

Place Profile Into Joint Gap, Inflate And Remove Excess Adhesive.

Jeene "W" Profile Shown
Jeene "FW" Profile Similar
 (SLAB-TO-SLAB CONDITION)

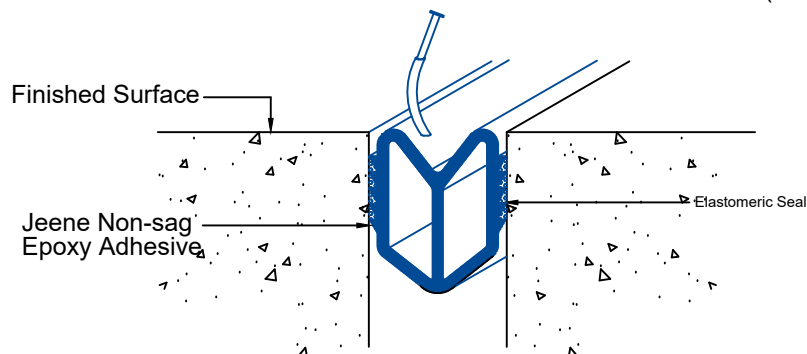

Cap Jeene Seal And Area Will Be Open To Traffic Immediately

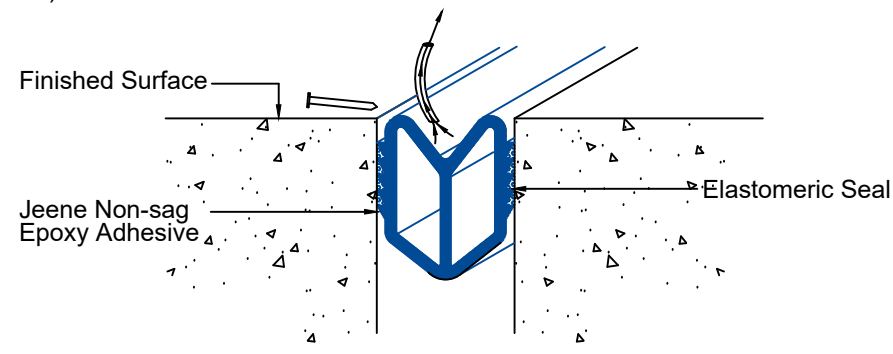

RELEASE AIR FROM PROFILE AFTER 24 HOURS.

PROJECT NAME: -

PROJECT LOCATION: -

DRAWING DESCRIPTION:

Wabo®Jeene

DATE: 01/28/2021

MODEL: FW & W



Watson Bowman Acme
 95 Pineview Drive Amherst, NY 14228
 phone: (716) 691-7566 fax: (716) 691-9239
www.watsonbowmanacme.com



Information provided herein, including but not limited to, any drawing, design, photograph, graphic, or statement(s) ("Materials") are proprietary and the property of Watson Bowman Acme Corporation ("Company"). Reproduction, translation, or reduction to any electronic medium or machine readable form, in whole or part, is strictly prohibited, except for the express purpose for which it has been furnished, without prior written consent of Company. All Materials contained herein are provided by Company for information purposes only. Company reserves the right to amend or withdraw any information contained in the Materials without notice. All technical or other advice by Company, whether verbal or written, concerning products, or the use of products in specific situations ("Advice") is given by Company and is used at the Users own risk.

REVISION NO:

1

SHEET NO:

5

DRAWING NO:

C-96011

PLAN VIEW

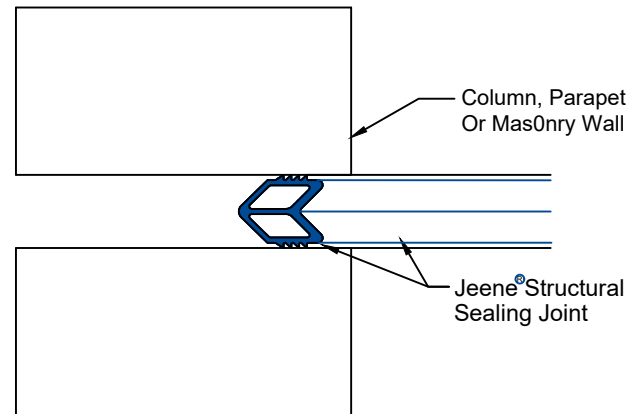

SIDE VIEW

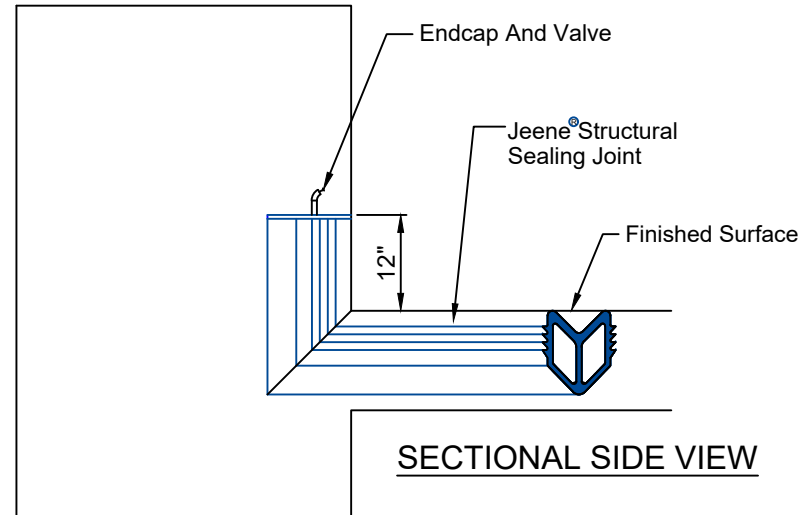

JOINT TERMINATION AT SPLIT COLUMN OR PARAPET

Note:
Jeene® "W" Profile Shown
Jeene® "FW" Profile Similar

PROJECT NAME:
-

PROJECT LOCATION:
-

DRAWING DESCRIPTION:

Wabo®Jeene

DATE: 01/28/2021

MODEL: FW & W



Watson Bowman Acme
95 Pineview Drive Amherst, NY 14228
phone: (716) 691-7566 fax: (716) 691-9239
www.watsonbowmanacme.com



Information provided herein, including but not limited to, any drawing, design, photograph, graphic, or statement(s) ("Materials") are proprietary and the property of Watson Bowman Acme Corporation ("Company"). Reproduction, translation, or reduction to any electronic medium or machine readable form, in whole or part, is strictly prohibited, except for the express purpose for which it has been furnished, without prior written consent of Company. All Materials contained herein are provided by Company for information purposes only. Company reserves the right to amend or withdraw any information contained in the Materials without notice. All technical or other advice by Company, whether verbal or written, concerning products, or the use of products in specific situations ("Advice") is given by Company and is used at the Users own risk.

REVISION NO:

1

SHEET NO:

6

DRAWING NO:

C-96011

Field Fabricate Curb Transition
Following Manufacturer's
Written Instructions

Detail Illustrated For Concept Only
Actual Project Conditions May Vary

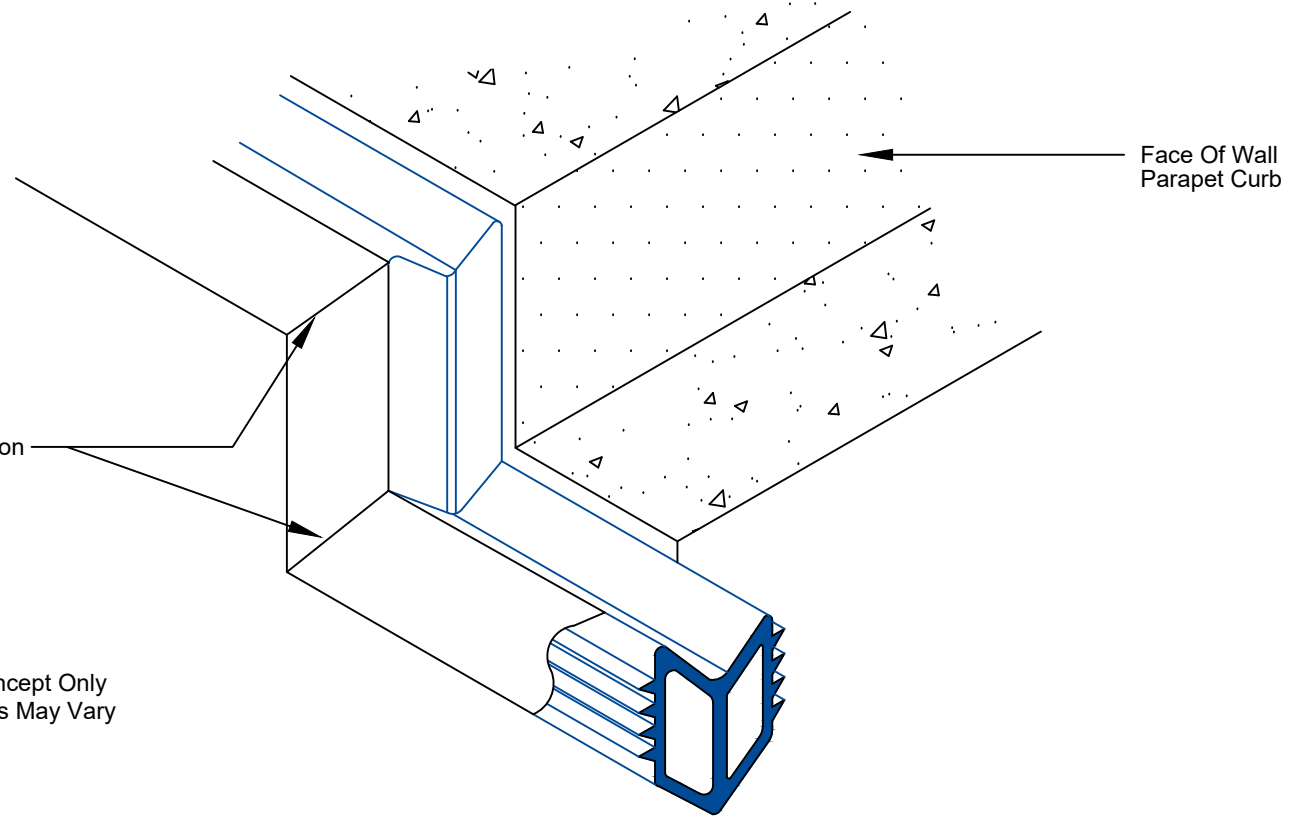

90° MITERED JEENE DETAIL

Jeene® "W" Profile Shown
Jeene® "FW" Profile Similar

PROJECT NAME: -

PROJECT LOCATION: -

DRAWING DESCRIPTION:

Wabo®Jeene

DATE: 01/28/2021

MODEL: FW & W



Watson Bowman Acme
95 Pineview Drive Amherst, NY 14228
phone: (716) 691-7566 fax: (716) 691-9239
www.watsonbowmanacme.com



Information provided herein, including but not limited to, any drawing, design, photograph, graphic, or statement(s) ("Materials") are proprietary and the property of Watson Bowman Acme Corporation ("Company"). Reproduction, translation, or reduction to any electronic medium or machine readable form, in whole or part, is strictly prohibited, except for the express purpose for which it has been furnished, without prior written consent of Company. All Materials contained herein are provided by Company for information purposes only. Company reserves the right to amend or withdraw any information contained in the Materials without notice. All technical or other advice by Company, whether verbal or written, concerning products, or the use of products in specific situations ("Advice") is given by Company and is used at the Users own risk.

REVISION NO:

1

SHEET NO:

7

DRAWING NO:

C-96011

Field Fabrication Expansion Joint
Transition Following Manufacturer's
Written Instructions

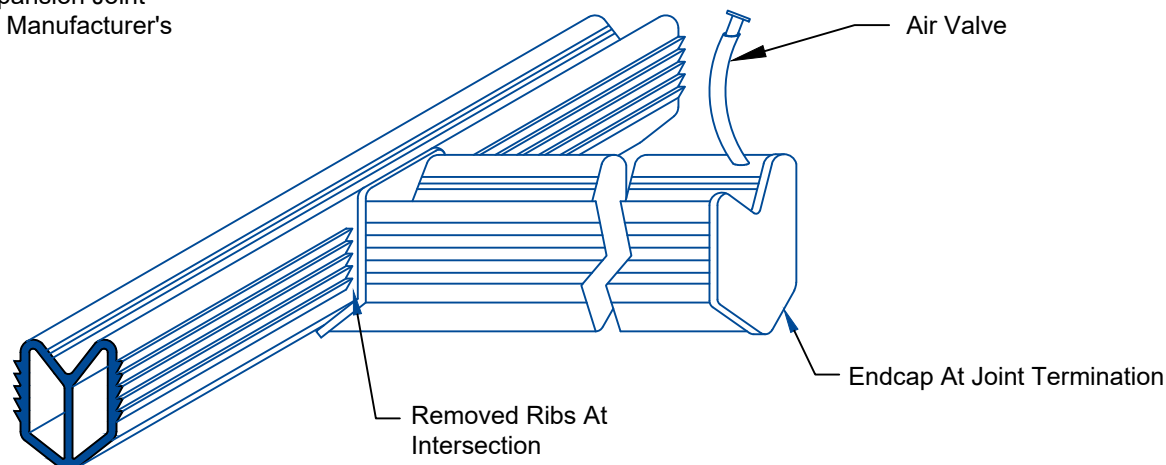

JOINT 3-WAY INTERSECTION ISOMETRIC

"T" SECTION SPLICE DETAIL
Jeene® "W" Profile Shown
Jeene® "FW" Profile Similar

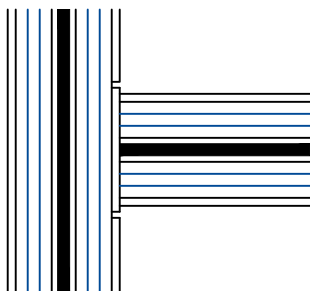

JOINT 3-WAY INTERSECTION PLAN

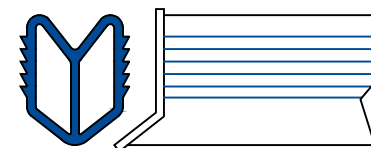

JOINT INTERSECTION PRIOR TO ASSEMBLY

PROJECT NAME: -

PROJECT LOCATION: -

DRAWING DESCRIPTION:

Wabo®Jeene

DATE: 01/28/2021

MODEL: FW & W



Information provided herein, including but not limited to, any drawing, design, photograph, graphic, or statement(s) ("Materials") are proprietary and the property of Watson Bowman Acme Corporation ("Company"). Reproduction, translation, or reduction to any electronic medium or machine readable form, in whole or part, is strictly prohibited, except for the express purpose for which it has been furnished, without prior written consent of Company. All Materials contained herein are provided by Company for information purposes only. Company reserves the right to amend or withdraw any information contained in the Materials without notice. All technical or other advice by Company, whether verbal or written, concerning products, or the use of products in specific situations ("Advice") is given by Company and is used at the Users own risk.

Watson Bowman Acme
95 Pineview Drive Amherst, NY 14228
phone: (716) 691-7566 fax: (716) 691-9239
www.watsonbowmanacme.com



REVISION NO:

1

SHEET NO:

8

DRAWING NO:

C-96011

Field Fabrication Expansion Joint
Transition Following Manufacturer's
Written Instructions

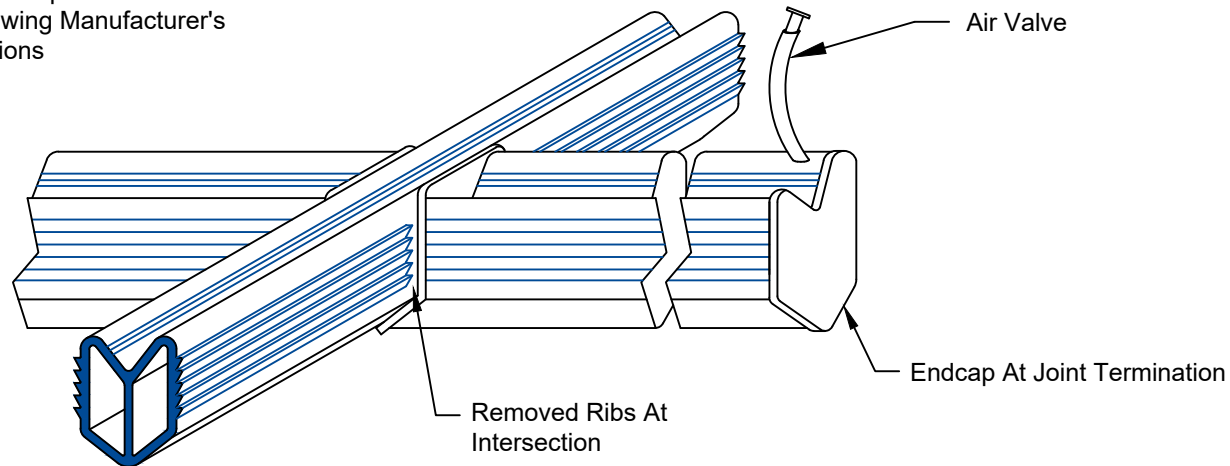

JOINT 4-WAY INTERSECTION ISOMETRIC

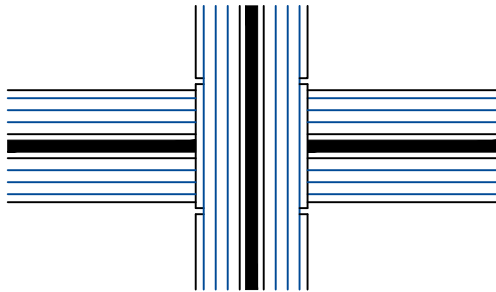

JOINT 4-WAY INTERSECTION PLAN

"X" SECTION SPLICE DETAIL
Jeene® "W" Profile Shown
Jeene® "FW" Profile Similar



JOINT INTERSECTION PRIOR TO ASSEMBLY

PROJECT NAME:
-

PROJECT LOCATION:
-

DRAWING DESCRIPTION:

Wabo®Jeene

DATE: 01/28/2021

MODEL: FW & W



Watson Bowman Acme
95 Pineview Drive Amherst, NY 14228
phone: (716) 691-7566 fax: (716) 691-9239
www.watsonbowmanacme.com



Information provided herein, including but not limited to, any drawing, design, photograph, graphic, or statement(s) ("Materials") are proprietary and the property of Watson Bowman Acme Corporation ("Company"). Reproduction, translation, or reduction to any electronic medium or machine readable form, in whole or part, is strictly prohibited, except for the express purpose for which it has been furnished, without prior written consent of Company. All Materials contained herein are provided by Company for information purposes only. Company reserves the right to amend or withdraw any information contained in the Materials without notice. All technical or other advice by Company, whether verbal or written, concerning products, or the use of products in specific situations ("Advice") is given by Company and is used at the Users own risk.

REVISION NO:

1

SHEET NO:

9

DRAWING NO:

C-96011

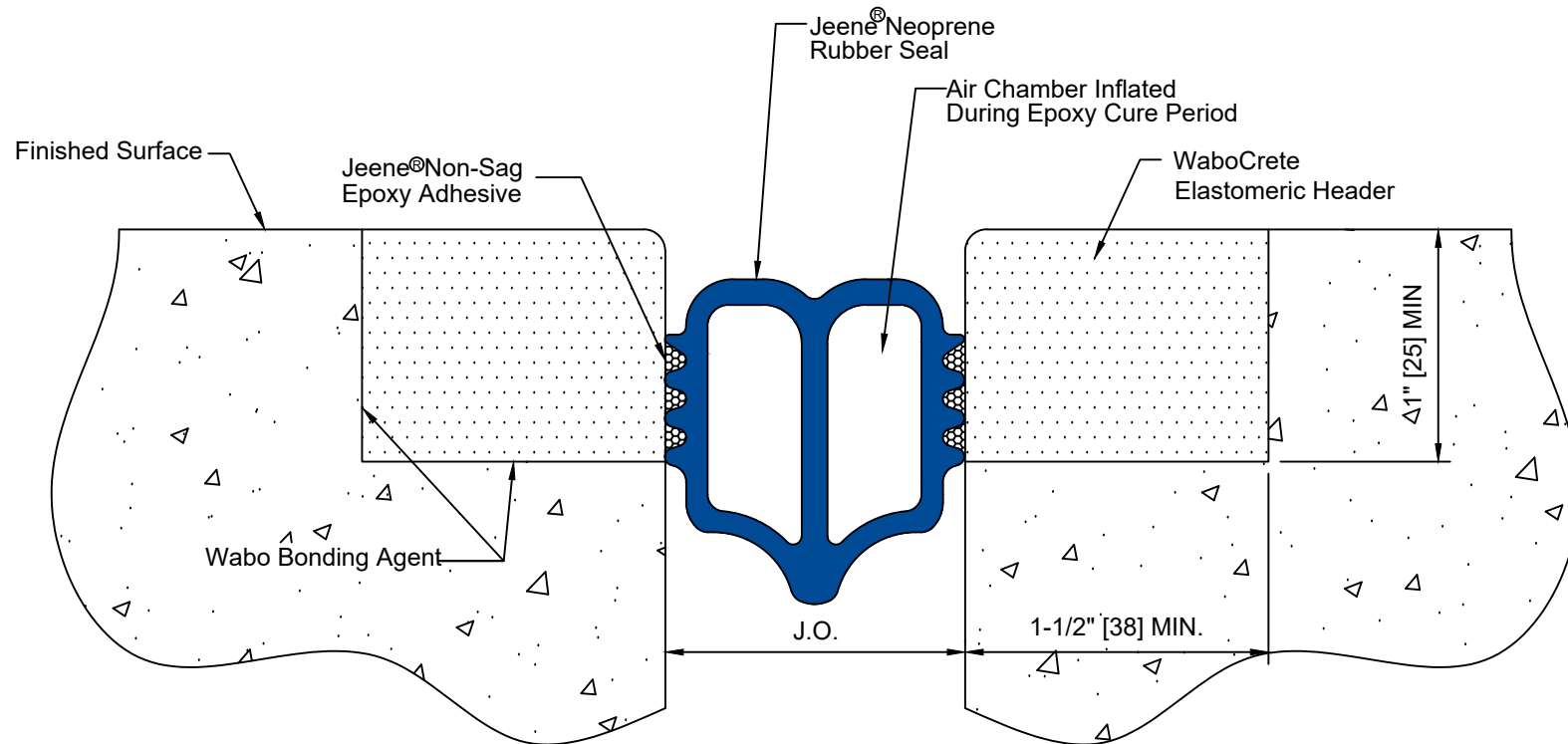

Rehab Condition

SLAB-TO-SLAB CONDITION

Dimensions Shown Are Minimum Requirements. Adjust Dimensions To Suit Any Voids Resulting From The Removal Of Existing Expansion Joint System (if Applicable) and System Depth.

PROJECT NAME:	-
PROJECT LOCATION:	-
DRAWING DESCRIPTION:	Wabo®Jeene
DATE: 01/28/2021	MODEL: FW



Information provided herein, including but not limited to, any drawing, design, photograph, graphic, or statement(s) ("Materials") are proprietary and the property of Watson Bowman Acme Corporation ("Company"). Reproduction, translation, or reduction to any electronic medium or machine readable form, in whole or part, is strictly prohibited, except for the express purpose for which it has been furnished, without prior written consent of Company. All Materials contained herein are provided by Company for information purposes only. Company reserves the right to amend or withdraw any information contained in the Materials without notice. All technical or other advice by Company, whether verbal or written, concerning products, or the use of products in specific situations ("Advice") is given by Company and is used at the Users own risk.

Watson Bowman Acme
95 Pineview Drive Amherst, NY 14228
phone: (716) 691-7566 fax: (716) 691-9239
www.watsonbowmanacme.com



REVISION NO:	1
SHEET NO:	10
DRAWING NO:	C-96011

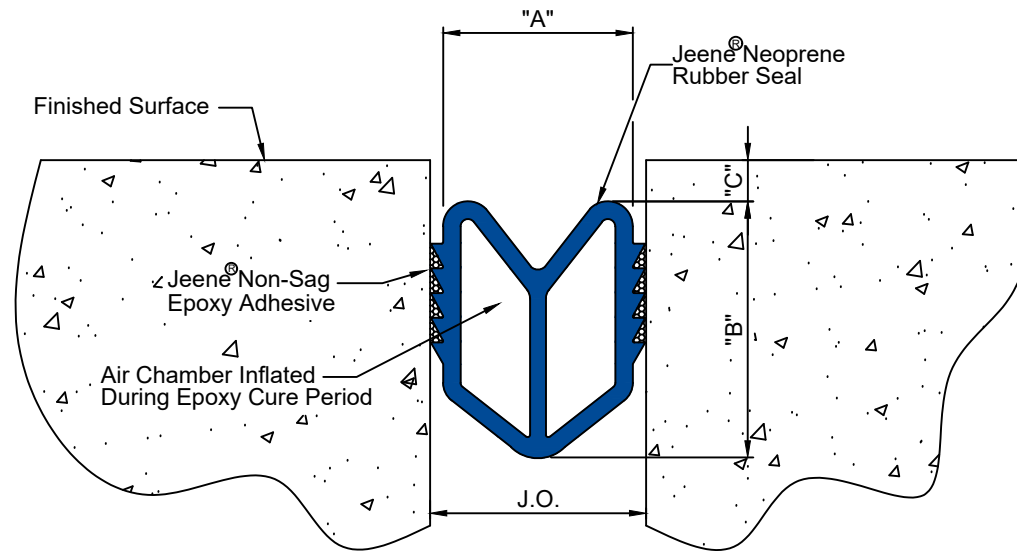

"W" PROFILE
SLAB-TO-SLAB CONDITION

() - Denotes Millimeters

Nominal Relaxed Dimensions			Movement Range			
Model	"A"	"B"	J.O. Min.	"C"	J.O. Max.	Total Movement
25W	1"(25)	1 1/4"(32)	1/2"(13)	1/4"(6)	1-1/2"(38)	1"(25)
40W	1 5/8"(41)	2 1/4"(57)	3/4"(19)	1/4"(6)	2 1/4"(57)	1 1/2"(38)
50W	2"(51)	2-3/4"(70)	1"(25)	1/4"(6)	3"(76)	2"(51)
65W	2 1/2"(64)	3 3/8"(86)	1 1/4"(32)	1/4"(6)	3 3/4"(95)	2 1/2"(65)
75W	3"(76)	3 7/8"(100)	1 1/2"(38)	1/4"(6)	4 1/2"(114)	3"(76)
100W	4"(102)	5 1/8"(129)	2"(51)	1/4"(6)	6"(152)	4"(102)

PROJECT NAME: -
PROJECT LOCATION: -
DRAWING DESCRIPTION: Wabo®Jeene
DATE: 01/28/2021



Watson Bowman Acme
95 Pineview Drive Amherst, NY 14228
phone: (716) 691-7566 fax: (716) 691-9239
www.watsonbowmanacme.com



Information provided herein, including but not limited to, any drawing, design, photograph, graphic, or statement(s) ("Materials") are proprietary and the property of Watson Bowman Acme Corporation ("Company"). Reproduction, translation, or reduction to any electronic medium or machine readable form, in whole or part, is strictly prohibited, except for the express purpose for which it has been furnished, without prior written consent of Company. All Materials contained herein are provided by Company for information purposes only. Company reserves the right to amend or withdraw any information contained in the Materials without notice. All technical or other advice by Company, whether verbal or written, concerning products, or the use of products in specific situations ("Advice") is given by Company and is used at the Users own risk.

REVISION NO: 1
SHEET NO: 2
DRAWING NO: C-96011

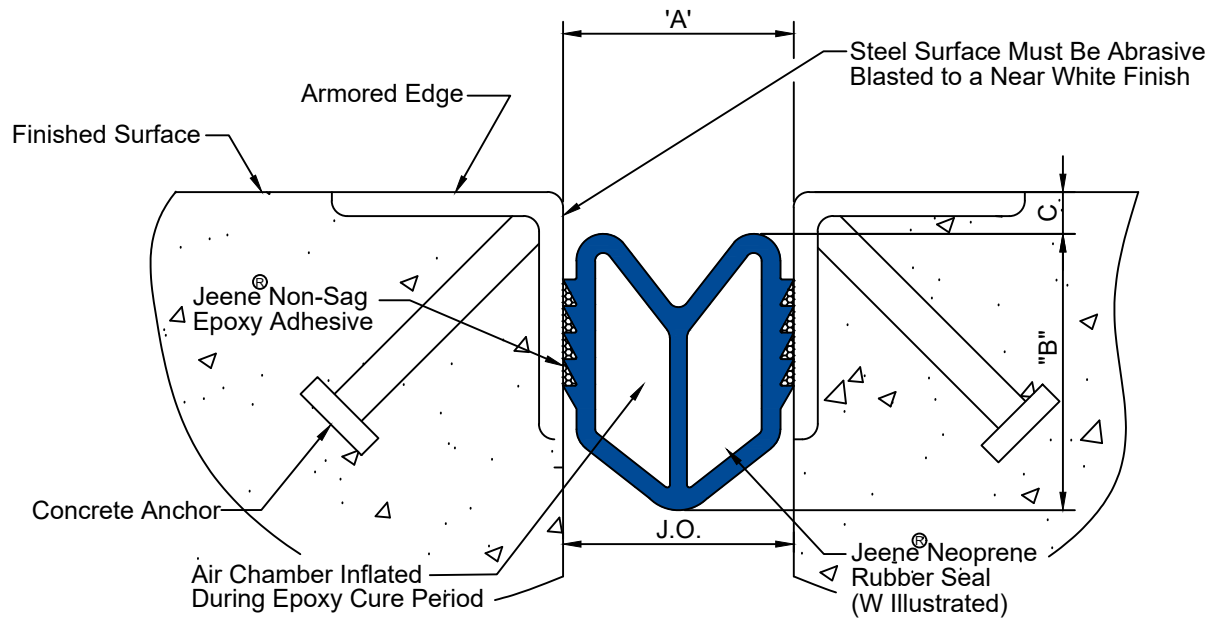

ARMORED CONDITION

SLAB-TO-SLAB CONDITION

() - Denotes Millimeters

Nominal Relaxed Dimensions			Movement Range			
Model	"A"	"B"	J.O. Min.	"C"	J.O. Max.	Total Movement
25W	1"(25)	1 1/4"(32)	1/2"(13)	1/4"(6)	1-1/2"(38)	1"(25)
40W	1 5/8"(41)	2 1/4"(57)	3/4"(19)	1/4"(6)	2 1/4"(57)	1 1/2"(38)
50W	2"(51)	2-3/4"(70)	1"(25)	1/4"(6)	3"(76)	2"(51)
65W	2 1/2"(64)	3 3/8"(86)	1 1/4"(32)	1/4"(6)	3 3/4"(95)	2 1/2"(65)
75W	3"(76)	3 7/8"(100)	1 1/2"(38)	1/4"(6)	4 1/2"(114)	3"(76)
100W	4"(102)	5 1/8"(129)	2"(51)	1/4"(6)	6"(152)	4"(102)

PROJECT NAME: -

PROJECT LOCATION: -

DRAWING DESCRIPTION:

Wabo®Jeene

DATE: 01/28/2021

MODEL: W



Watson Bowman Acme
95 Pineview Drive Amherst, NY 14228
phone: (716) 691-7566 fax: (716) 691-9239
www.watsonbowmanacme.com



Information provided herein, including but not limited to, any drawing, design, photograph, graphic, or statement(s) ("Materials") are proprietary and the property of Watson Bowman Acme Corporation ("Company"). Reproduction, translation, or reduction to any electronic medium or machine readable form, in whole or part, is strictly prohibited, except for the express purpose for which it has been furnished, without prior written consent of Company. All Materials contained herein are provided by Company for information purposes only. Company reserves the right to amend or withdraw any information contained in the Materials without notice. All technical or other advice by Company, whether verbal or written, concerning products, or the use of products in specific situations ("Advice") is given by Company and is used at the Users own risk.

REVISION NO:

1

SHEET NO:

3

DRAWING NO:

C-96011